

φ 22ギヤードモータ Gear Motor

コアレスモータ Coreless Motor

コアレスモータ Coreless Motor **SCR18-37××** page42

遊星ギヤヘッド Planetary Gearhead **IG-22V** page64

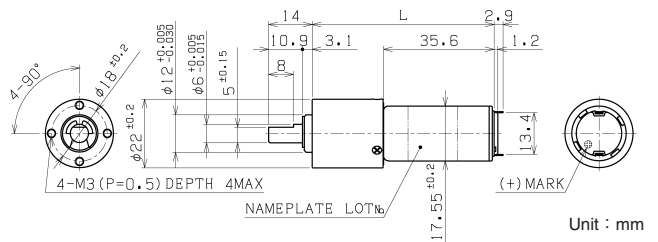

IG-22VM-SRV3702B-06		DC6V		起動電流 Starting current 1940mA				
減速比 Reduction Ratio (1/i)	無負荷回転数 No-Load Speed min ⁻¹	定格回転数 Rated Speed min ⁻¹	定格トルク Rated Torque			起動トルク Starting Torque mNm	長さ(L) Length mm	回転方向 Direction of rotation
			mNm	kg·cm	oz·in			
4	1950	1480	9.32	0.095	1.32	(38.7)	53.5	CW
16	488	374	29.4	0.30	4.17	(126)	58.7	CW
19	411	316	34.3	0.35	4.86	(148)	58.7	CW
22	346	269	39.2	0.4	5.56	(176)	58.7	CW
64	122	92.3	98.1	1.0	13.9	(403)	63.9	CW
76	103	77.5	118	1.2	16.7	(477)	63.9	CW
90	86.5	65.6	137	1.4	19.4	(567)	63.9	CW
107	72.8	54.9	167	1.7	23.6	(679)	63.9	CW
256	30.5	23.0	324	3.3	45.8	(1318)	69.1	CW
304	25.7	19.4	382	3.9	54.2	(1558)	69.1	CW
361	21.6	16.3	451	4.6	63.9	(1838)	69.1	CW
428	18.2	13.7	539	5.5	76.4	(2180)	69.1	CW
509	15.3	11.6	637	6.5	90.3	(2634)	69.1	CW

IG-22VM-SRV3703B-12		DC12V		起動電流 Starting current 2260mA				
減速比 Reduction Ratio (1/i)	無負荷回転数 No-Load Speed min ⁻¹	定格回転数 Rated Speed min ⁻¹	定格トルク Rated Torque			起動トルク Starting Torque mNm	長さ(L) Length mm	回転方向 Direction of rotation
			mNm	kg·cm	oz·in			
4	2420	2150	9.32	0.095	1.32	(83.5)	53.5	CW
16	604	539	29.4	0.30	4.17	(273)	58.7	CW
19	509	454	34.3	0.35	4.86	(317)	58.7	CW
22	429	384	39.2	0.4	5.56	(374)	58.7	CW
64	151	134	98.1	1.0	13.9	(871)	63.9	CW
76	127	113	118	1.2	16.7	(1070)	63.9	CW
90	107	95.1	137	1.4	19.4	(1232)	63.9	CW
107	90.2	79.9	167	1.7	23.6	(1462)	63.9	CW
256	37.8	33.4	324	3.3	45.8	(2783)	69.1	CW
304	31.8	28.2	382	3.9	54.2	(3374)	69.1	CW
361	26.8	23.7	451	4.6	63.9	(3899)	69.1	CW
428	22.6	20.0	539	5.5	76.4	(4685)	69.1	CW
509	19.0	16.8	637	6.5	90.3	(5501)	69.1	CW

IG-22VM-SRV3705B-12		DC12V		起動電流 Starting current 1450mA				
減速比 Reduction Ratio (1/i)	無負荷回転数 No-Load Speed min ⁻¹	定格回転数 Rated Speed min ⁻¹	定格トルク Rated Torque			起動トルク Starting Torque mNm	長さ(L) Length mm	回転方向 Direction of rotation
			mNm	kg·cm	oz·in			
4	2050	1750	9.32	0.095	1.32	(63.7)	53.5	CW
16	513	439	29.4	0.30	4.17	(204)	58.7	CW
19	432	371	34.3	0.35	4.86	(243)	58.7	CW
22	364	314	39.2	0.4	5.56	(285)	58.7	CW
64	128	109	98.1	1.0	13.9	(661)	63.9	CW
76	108	91.7	118	1.2	16.7	(782)	63.9	CW
90	90.9	77.5	137	1.4	19.4	(929)	63.9	CW
107	76.5	65.0	167	1.7	23.6	(1111)	63.9	CW
256	32.0	27.2	324	3.3	45.8	(2160)	69.1	CW
304	27.0	22.9	382	3.9	54.2	(2516)	69.1	CW
361	22.7	19.3	451	4.6	63.9	(3011)	69.1	CW
428	19.1	16.3	539	5.5	76.4	(3677)	69.1	CW
509	16.1	13.7	637	6.5	90.3	(4273)	69.1	CW

IG-22VM-SRV3712B-12		DC12V		起動電流 Starting current 411mA				
減速比 Reduction Ratio (1/i)	無負荷回転数 No-Load Speed min ⁻¹	定格回転数 Rated Speed min ⁻¹	定格トルク Rated Torque			起動トルク Starting Torque mNm	長さ(L) Length mm	回転方向 Direction of rotation
			mNm	kg·cm	oz·in			
4	738	583	9.81	0.10	1.39	(46.7)	53.5	CW
16	184	137	39.2	0.40	5.56	(153)	58.7	CW
19	155	113	49.0	0.50	6.95	(181)	58.7	CW
22	131	98.0	53.9	0.55	7.64	(214)	58.7	CW
64	46.1	34.1	127	1.3	18.1	(488)	63.9	CW
76	38.8	28.4	157	1.6	22.2	(586)	63.9	CW
90	32.7	23.9	186	1.9	26.4	(691)	63.9	CW
107	27.5	20.3	216	2.2	30.6	(825)	63.9	CW
256	11.5	8.40	431	4.4	61.1	(1599)	69.1	CW
304	9.70	7.09	510	5.2	72.2	(1895)	69.1	CW
361	8.17	5.96	608	6.2	86.1	(2248)	69.1	CW
428	6.88	5.03	716	7.3	101	(2663)	69.1	CW
509	5.79	4.36	785	8.0	111	(3178)	69.1	CW

IG-22VM-SRV3713B-12		DC12V		起動電流 Starting current 2550mA				
減速比 Reduction Ratio (1/i)	無負荷回転数 No-Load Speed min ⁻¹	定格回転数 Rated Speed min ⁻¹	定格トルク Rated Torque			起動トルク Starting Torque mNm	長さ(L) Length mm	回転方向 Direction of rotation
			mNm	kg·cm	oz·in			
4	2500	2080	14.7	0.15	2.08	(87.5)	53.5	CW
16	624	517	49.0	0.5	6.95	(286)	58.7	CW
19	525	435	58.8	0.6	8.34	(343)	58.7	CW
22	443	368	68.6	0.7	9.72	(405)	58.7	CW
64	156	129	157	1.6	22.2	(907)	63.9	CW
76	131	108	196	2.0	27.8	(1116)	63.9	CW
90	111	91.4	226	2.3	32.0	(1280)	63.9	CW
107	93.2	76.6	275	2.8	38.9	(1544)	63.9	CW
256	39.0	32.0	539	5.5	76.4	(3003)	69.1	CW
304	32.8	27.0	637	6.5	90.3	(3602)	69.1	CW
361	27.7	22.7	755	7.7	107	(4183)	69.1	CW
428	23.3	19.6	785	8.0	111	(4943)	69.1	CW
509	19.6	17.0	785	8.0	111	(5918)	69.1	CW

IG-22VM-SRV3710B-24		DC24V		起動電流 Starting current 745mA				
減速比 Reduction Ratio (1/i)	無負荷回転数 No-Load Speed min ⁻¹	定格回転数 Rated Speed min ⁻¹	定格トルク Rated Torque			起動トルク Starting Torque mNm	長さ(L) Length mm	回転方向 Direction of rotation
			mNm	kg·cm	oz·in			
4	2720	2190	9.32	0.095	1.32	(47.8)	53.5	CW
16	679	552	29.4	0.30	4.17	(157)	58.7	CW
19	572	467	34.3	0.35	4.86	(187)	58.7	CW
22	482	396	39.2	0.4	5.56	(220)	58.7	CW
64	170	137	98.1	1.0	13.9	(505)	63.9	CW
76	143	115	118	1.2	16.7	(603)	63.9	CW
90	120	97.2	137	1.4	19.4	(721)	63.9	CW
107	101	81.4	167	1.7	23.6	(861)	63.9	CW
256	42.5	34.1	324	3.3	45.8	(1639)	69.1	CW
304	35.8	28.7	382	3.9	54.2	(1926)	69.1	CW
361	30.1	24.2	451	4.6	63.9	(2301)	69.1	CW
428	25.4	20.4	539	5.5	76.4	(2738)	69.1	CW
509	21.4	17.2	637	6.5	90.3	(3246)	69.1	CW

IG-22VM-SRV3714B-24		DC24V		起動電流 Starting current 311mA				
減速比 Reduction Ratio (1/i)	無負荷回転数 No-Load Speed min ⁻¹	定格回転数 Rated Speed min ⁻¹	定格トルク Rated Torque			起動トルク Starting Torque mNm	長さ(L) Length mm	回転方向 Direction of rotation
			mNm	kg·cm	oz·in			
4	1120	889	9.81	0.10	1.39	(47.6)	53.5	CW
16	281	209	39.2	0.40	5.56	(153)	58.7	CW
19	237	173	49.0	0.50	6.95	(181)	58.7	CW
22	199	149	53.9	0.55	7.64	(215)	58.7	CW
64	70.3	52.0	127	1.3	18.1	(488)	63.9	CW
76	59.2	43.2	157	1.6	22.2	(581)	63.9	CW
90	49.8	36.4	186	1.9	26.4	(691)	63.9	CW
107	42.0	30.9	216	2.2	30.6	(817)	63.9	CW
256	17.6	12.8	431	4.4	61.1	(1580)	69.1	CW
304	14.8	10.8	510	5.2	72.2	(1887)	69.1	CW
361	12.5	9.08	608	6.2	86.1	(2222)	69.1	CW
428	10.5	7.67	716	7.3	101	(2657)	69.1	CW
509	8.83	6.64	785	8.0	111	(3165)	69.1	CW

IG-22VM-SRV3715B-24		DC24V		起動電流 Starting current 1580mA				
減速比 Reduction Ratio (1/i)	無負荷回転数 No-Load Speed min ⁻¹	定格回転数 Rated Speed min ⁻¹	定格トルク Rated Torque			起動トルク Starting Torque mNm	長さ(L) Length mm	回転方向 Direction of rotation
			mNm	kg·cm	oz·in			
4	2370	2080	14.7	0.15	2.08	(120)	53.5	CW
16	593	503	58.8	0.60	8.34	(387)	58.7	CW
19	499	420	73.5	0.75	10.4	(464)	58.7	CW
22	421	356	83.4	0.85	11.8	(540)	58.7	CW
64	148	125	196	2.0	27.8	(1261)	63.9	CW
76	125	105	235	2.4	33.3	(1469)	63.9	CW
90	105	88.7	275	2.8	38.9	(1771)	63.9	CW
107	88.5	74.4	333	3.4	47.2	(2090)	63.9	CW
256	37.1	31.1	647	6.6	91.7	(4001)	69.1	CW
304	31.2	26.2	765	7.8	108	(4774)	69.1	CW
361	26.3	22.7	785	8.0	111	(5735)	69.1	CW
428	22.1	19.6	785	8.0	111	(6939)	69.1	CW
509	18.6	16.8	785	8.0	111	(8112)	69.1	CW

標準品 Standard 1. 上記データは参考値です。 The above data is for reference only.
特注品 Custom-made 2. 上記スペックは一例で、要望スペックにて承ります。 The above specifications are an example and your specifications are welcomed.

索引 INDEX
 選定 Selection Guide
 技術情報 Technical Information
 Motor
 コアレス Coreless
 ブラシレス Brushless
 プラシレス Planetary
 エンコーダ Encoder
 磁気 Magnetic
 光学 Optical
 Gearhead
 Planetary
 Spur
 スパー
 Gear Motor
 コアレス Coreless
 Iron Core